

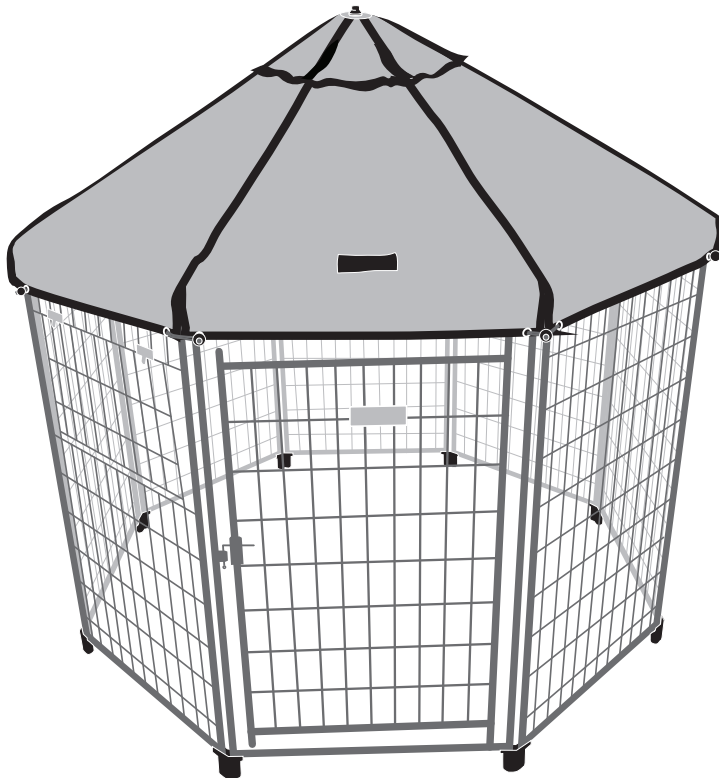

THE PET GAZEBO[®]
BY ADVANTEK

INSTRUCTION MANUAL



FOR 23230E, 23220E, 23200E, 23210E
23403, 23404, 23405, 23408

THE PET GAZEBO

PARTS SECTION:

A	Gate Panel	x 1
B	Latching Window Panel	x 1
C	Steel Panel	x 6
D	Nylon Connector	x 16
E	Self Tapping Set Screws	x 16
F	Roof Support Hub	x 1
G	Roof Arm Support	x 8
H	Ball Ties	x 8
I	Market Umbrella Cover	x 1
J	Roof Support Cap	x 1

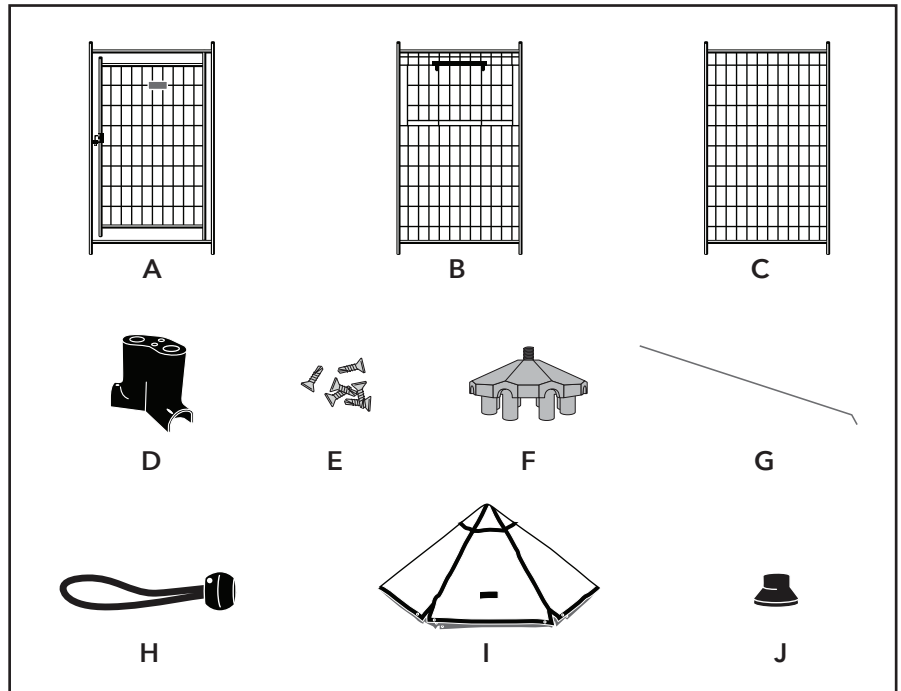

CONGRATULATIONS! WELCOME TO THE PET GAZEBO® FAMILY

The PET GAZEBO® provides your pet with a safe and secure place to play or rest. Whether you are using it indoors as a crate or outdoors in place of an ordinary exercise pen or kennel The PET GAZEBO® adds piece of mind with a flare for style.

Make sure to check out www.petgazebo.com regularly for the latest and greatest accessories to CUSTOMIZE your pets experience and make your life easier.

ASSEMBLY INSTRUCTIONS:

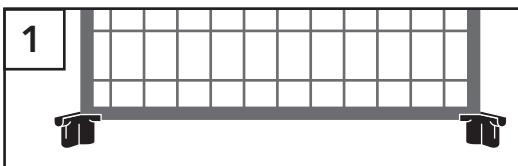

1 Begin with two Steel Panels . Place Nylon Panel Connectors on the bottom of both ends of one panel.

Note: All Nylon Panel Connectors are identical

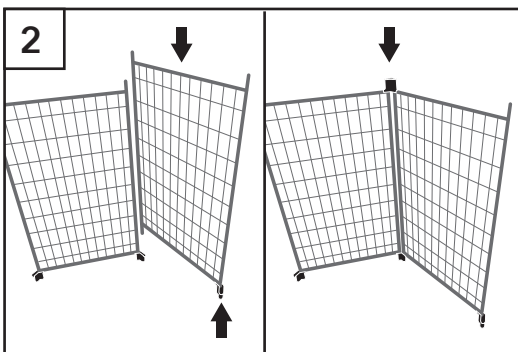

2 Place a Nylon Panel Connector on to one side of another Side Panel and insert the second Side Panel into a Nylon Panel Connector of the first Side Panel.

Attach a Nylon Panel Connector to join the 2 Side Panels at the top so the unit can stand freely.

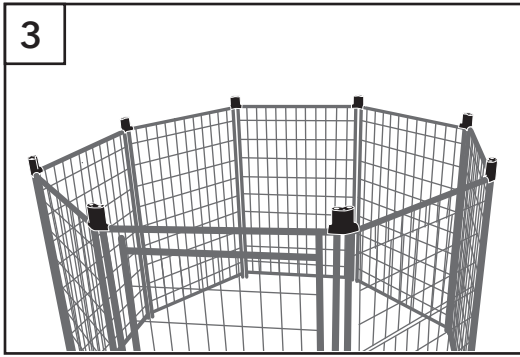

3 Repeat these steps until you have an octagonal shape. Make sure the **Gate Panel** and **Latching Window Panel** are placed where both panels can be opened from the outside.

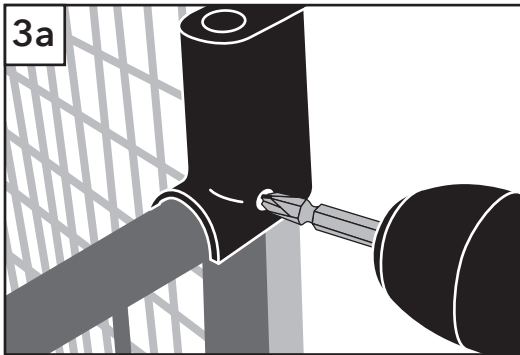

3a To turn your **Pet Gazebo** into a semi-permanent structure (optional), use a power drill and screw the **Self Tapping Screws** into the pre-drilled holes provided on the connectors for 234XX series.

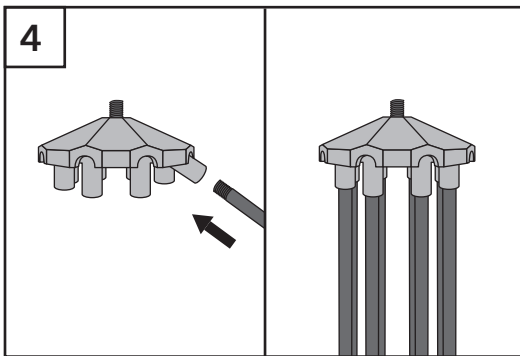

4 Insert the tip of the **Roof Support Arm** into the sleeve of the **Roof Hub** and screw into place by turning the **Support Arm** to the right (clockwise). Screw the arm in completely and make sure the angled end of the **Roof Arm** is pointing in towards the **Roof Hub**.

Repeat this step for the remaining 7 **Roof Support Arms**.

Once the **Roof Support Arms** are in place, it is recommended to leave them in the **Roof Hub** for future use.

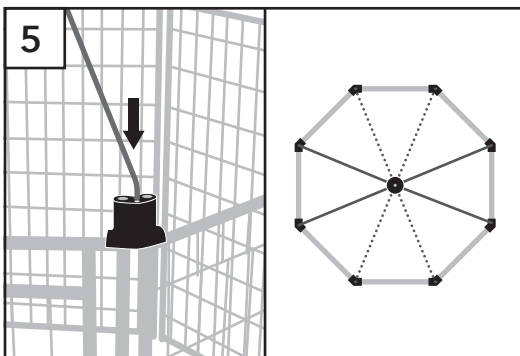

5 Insert the end of a **Roof Support Arm** into the larger hole of the **Nylon Panel Connector**.

For stability it is best to start with an "x" pattern. Continue putting the **Roof Support Arms** into place in the **Nylon Panel Connectors**.

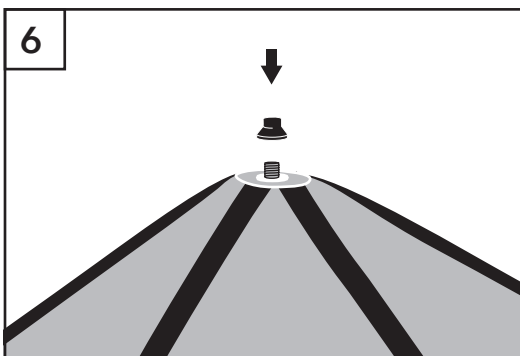

6 Make sure the **Market Umbrella Canopy** is oriented with the **Pet Gazebo** logo outward. Locate the center eyelet and line it up with the center of the **Roof Support Hub**.

Screw on the **Roof Support Cap** to attach the **Canopy** to the kennel.

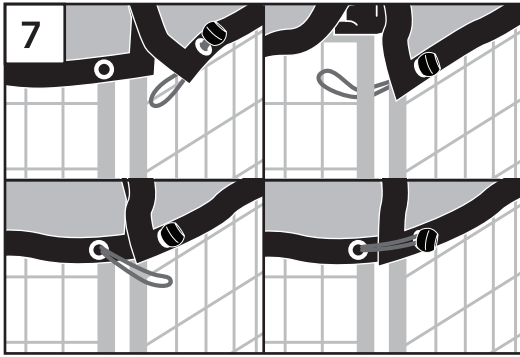

7 Using the **Ball Ties** provided attach the **Canopy** to the posts of the kennel.

Note: Align the ribs of the **Market Umbrella Canopy** with the posts of the panels. Insert a **Ball Tie** through the eyelet below the horizontal frame bar and wrap around the vertical frame post connecting two (2) **Panels** together.

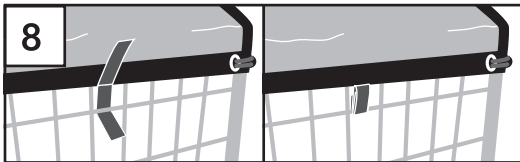

8 Pass the inside strap underneath the second horizontal bar from the top. Fold top of strap over bottom to secure.

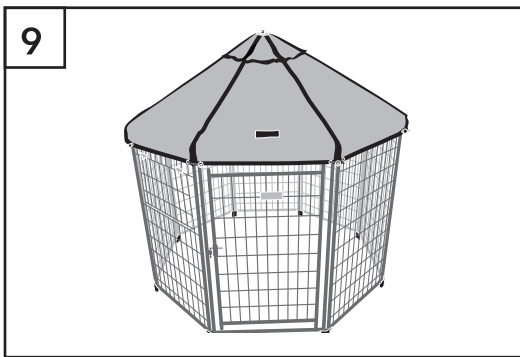

9 Your **Pet Gazebo** is now ready to use!

Note: For safety and stability when used outdoors the **Pet Gazebo** should be secured to the ground with steel ground stakes (Item #: 23396 & 23397).

CONNECTING MULTIPLE PET GAZEBOS TOGETHER

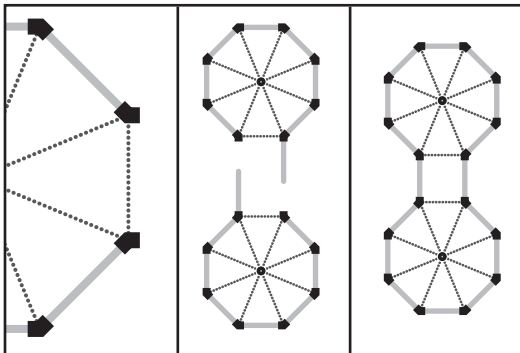

1 Detach a single **Kennel Side Panel** and its **Nylon Panel Connectors** from a fully assembled gazebo, then re-attach the **Nylon Panel Connectors** so that they turn away from the kennel side panel, rather than inward.

Re-attach a **Kennel Side Panel** to each gazebo so that the panels face outward and are on opposite sides.

Attach gazebos together by inserting the outward facing **Kennel Side Panels** in the available **Nylon Panel Connectors**.

WARRANTY

LIMITED WARRANTY

Steel panels (side panel, gate panel, window panel)
 Canopy 23200 series (Reversible Polyethylene)
 23400 series (Market top Polyester)
 Nylon connectors, roof support hub, cap, arms, ball ties

5 YEARS
1 YEAR
3 YEARS
1 YEAR

To activate your warranty: register your product at advantekpet.com/warranty. To request warranty replacement email warranty@advantekpet.com. Be sure to include a copy of your receipt, a photo of defective part(s) and a listing of part(s) needed. Be sure to include your name and contact information.